

# Adding Accessories

## >> Step 1

• Open the APP

• Login to the APP.

• Open the setting screen.

• Click View all

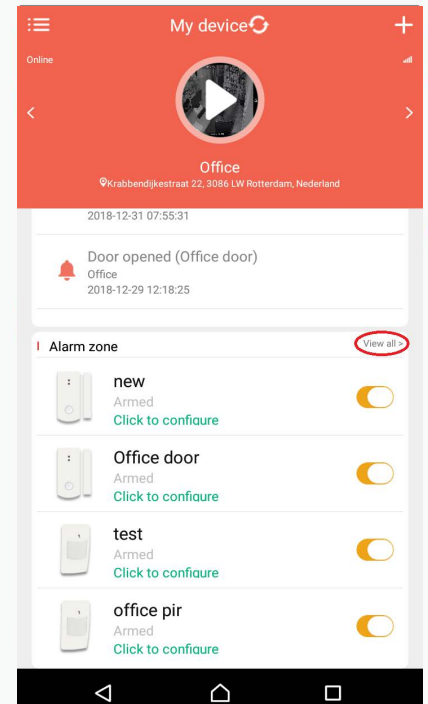
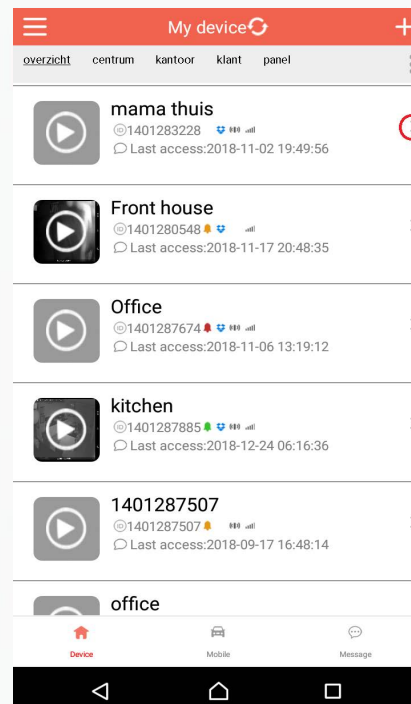
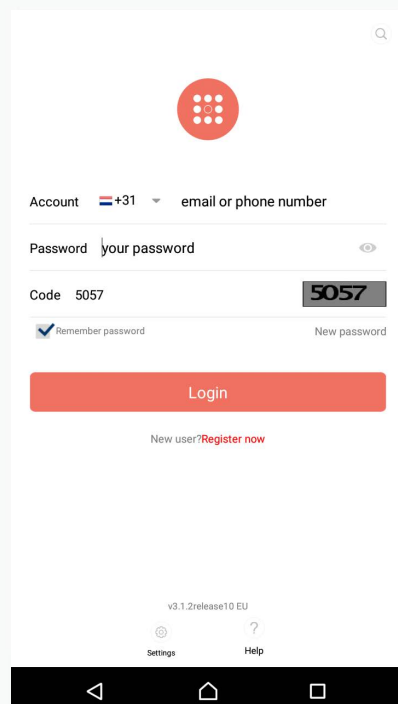

## >> Step 1

- Click the + sign (add sensors).

- The following screen appears.

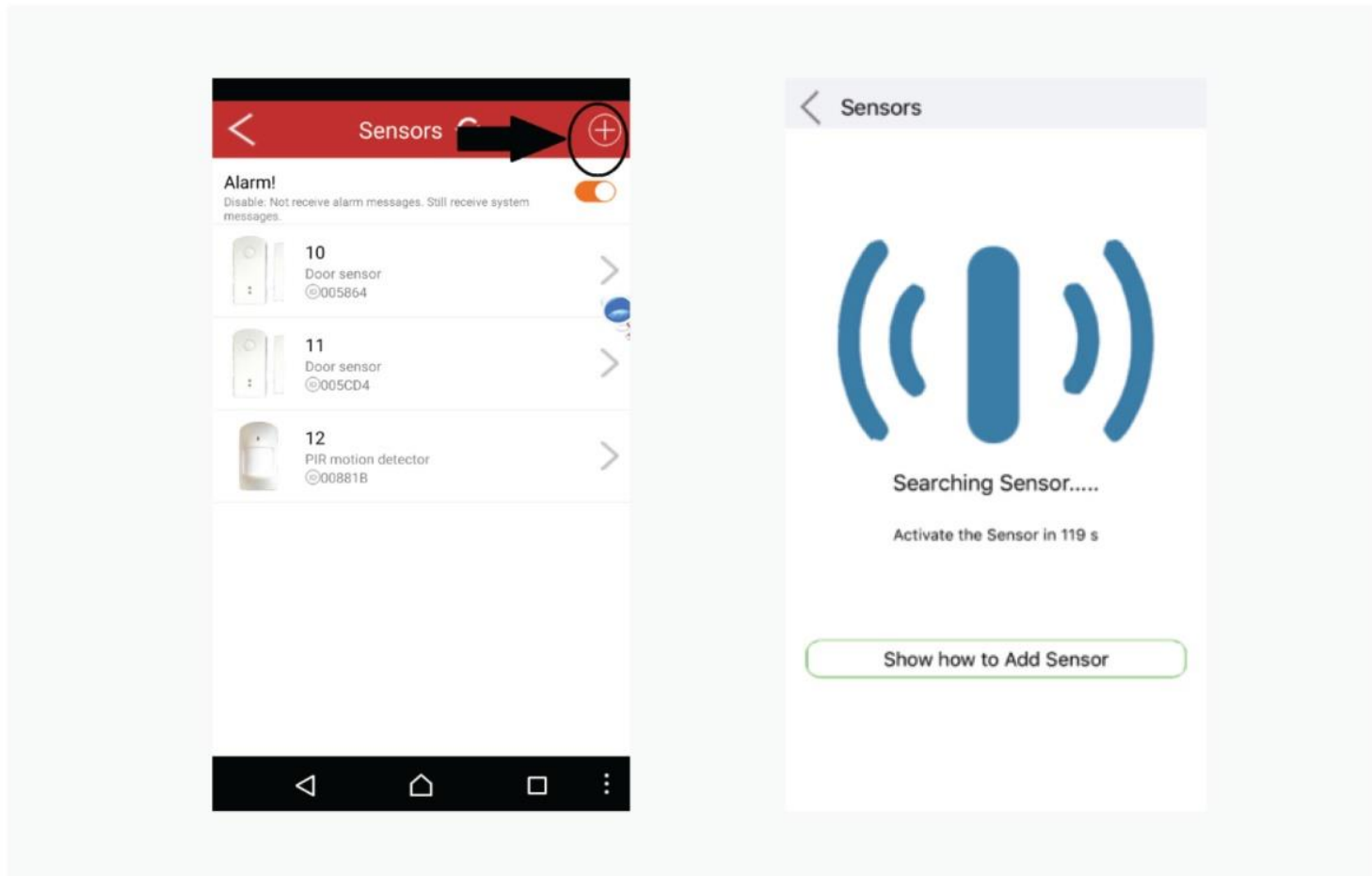

- Door sensor >> press the button



- PIR >> move with your hand



- Remote Control >> Press top button (disarm)



- Smoke sensor > press black button



- Indoor siren >> put in power outlet



- Outdoor siren >> put in power outlet



## » Step 1

Choose between these options or type in your own location name.  
After entering click the green button

The sensor is now added to your alarmsystem.

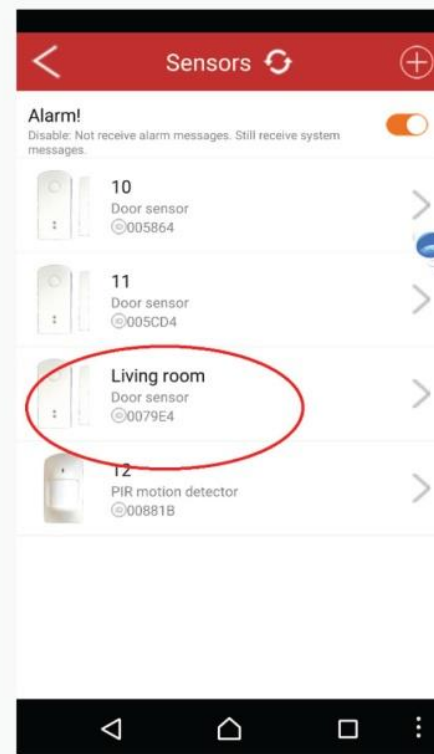
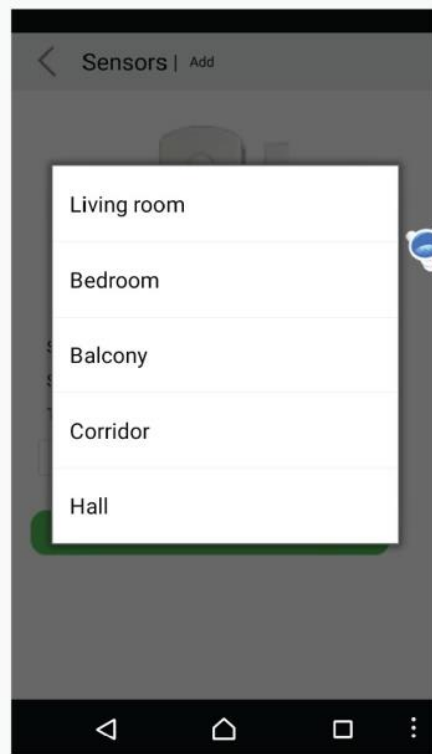

- To test the door sensor. Do not push the arm button.

- But take the 2 parts apart



## » Step 2

- Click the arrow for further settings

- Click here to change the location of the sensor

- Enable (colored) if you want the sensor to be active 24 hours per day. The sensor will also trigger the alarm when the alarm system is disarmed. This function is needed for smoke detectors.

- Enable this function (colored) if you want the siren to go off when alarm is triggered.

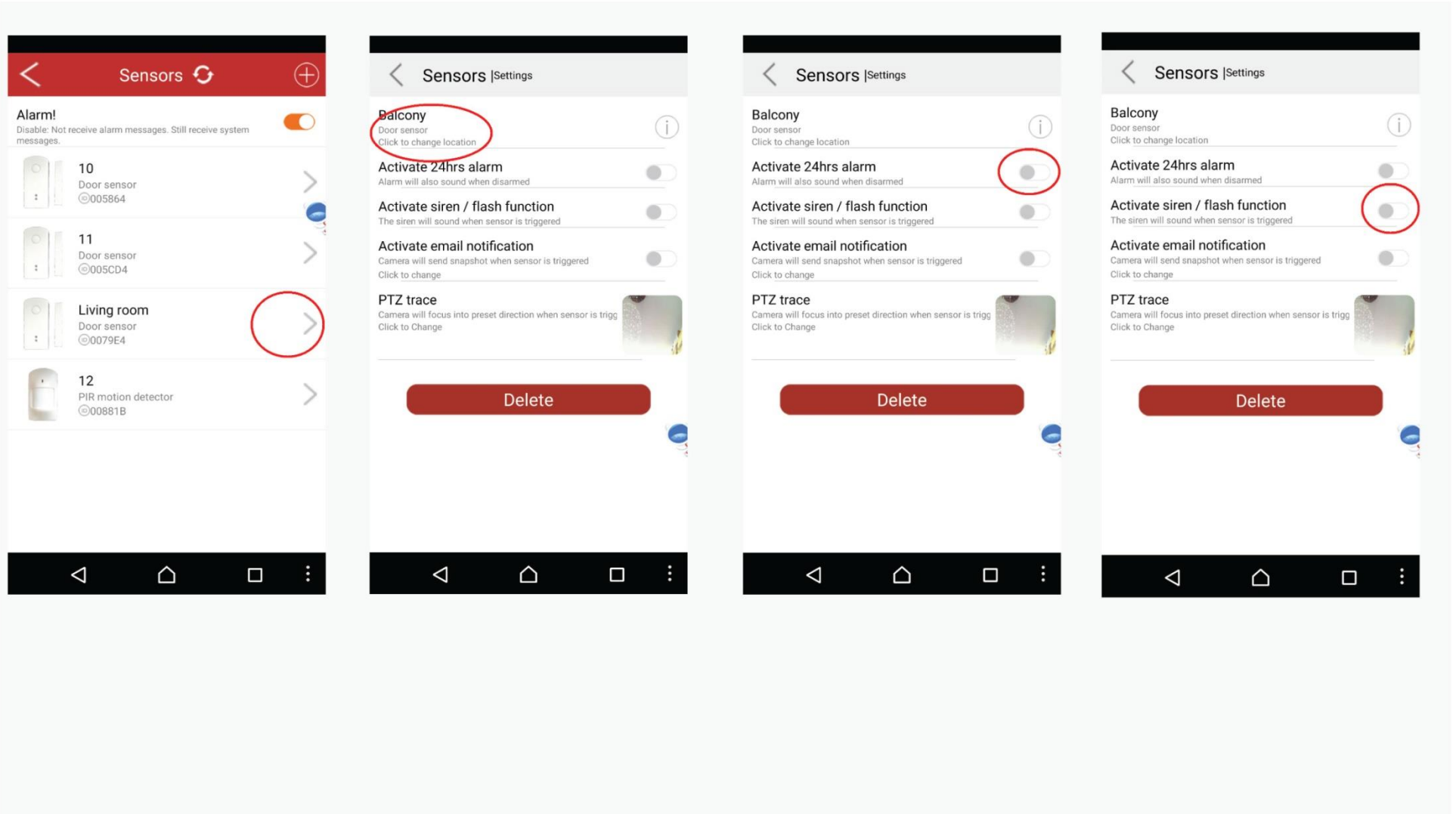

## » Step 2

- Enable this function to receive notifications in your email

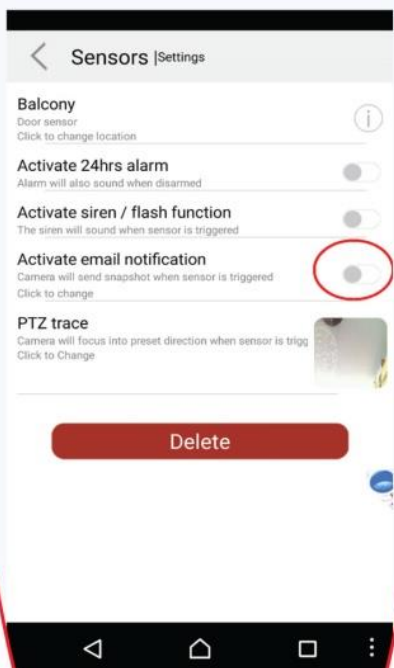

- Activating the PTZ function (autofocus of camera when alarm is triggered)

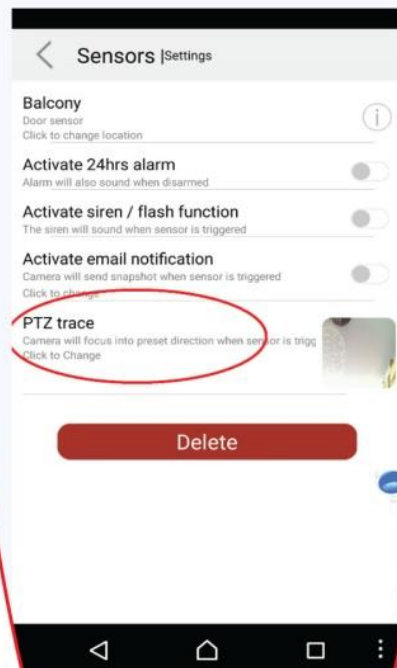

- Use the arrows to determine the PTZ position. **Notice :** The camera will move automatically to this position when the sensor is triggered. The camera will record immediately when triggered and make a snapshot when into position

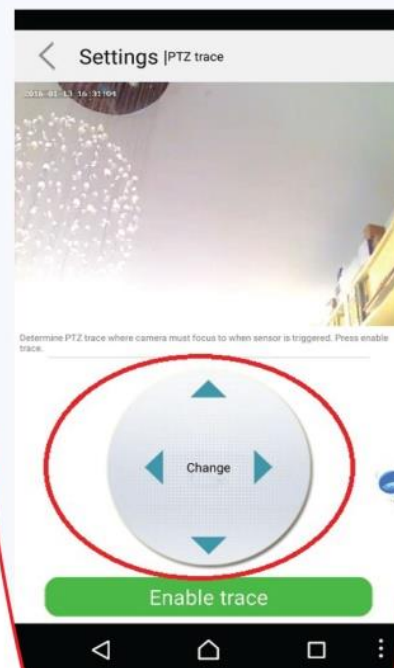

- Activating the PTZ function (autofocus of camera when alarm

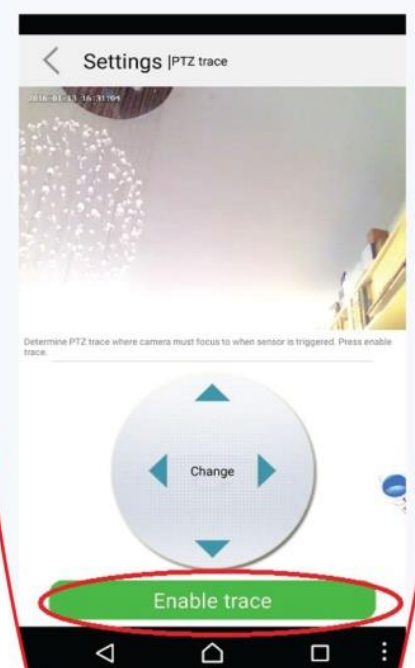

## » Step 3

- The sensor is now programmed with a preset position. Use this button to go back to main menu. If you want to delete the preset position press Disable trace.

- Go to Alarmplan sensor to automate time to arm and disarm the alarmsystem.

- Click +

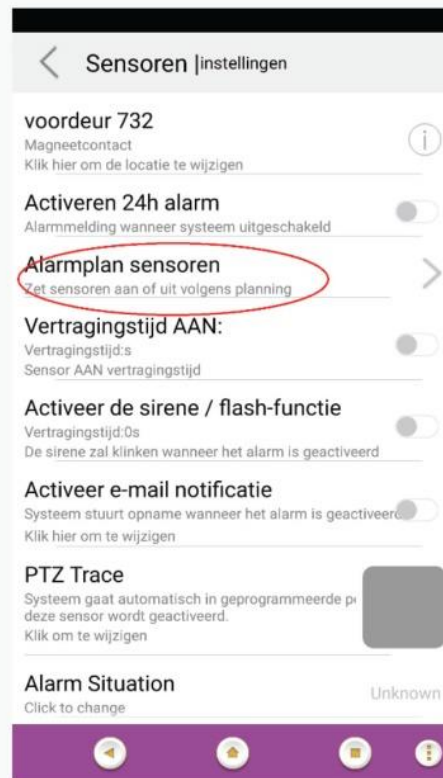
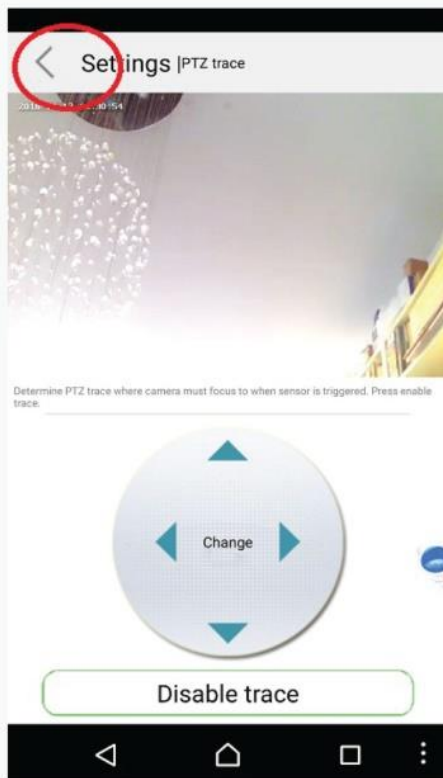

## » Step 3

- Determine to program time to switch system ON or OFF

Determine the days to switch system ON or OFF

- Finally determine the time to switch system ON or OFF

Press green button to confirm.

- Overview is showing added time.

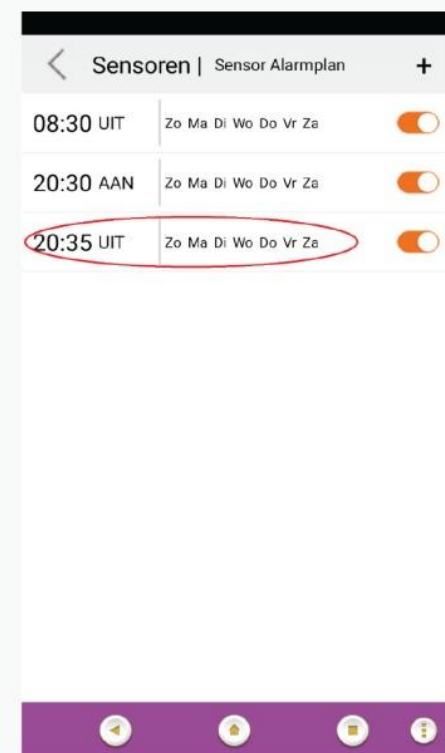
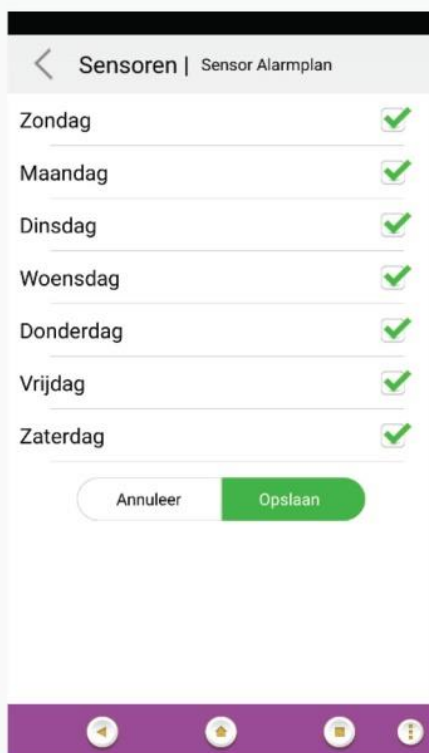

- In the app the alarmplan is shown per sensor.

You can determine different times per day and per sensor.

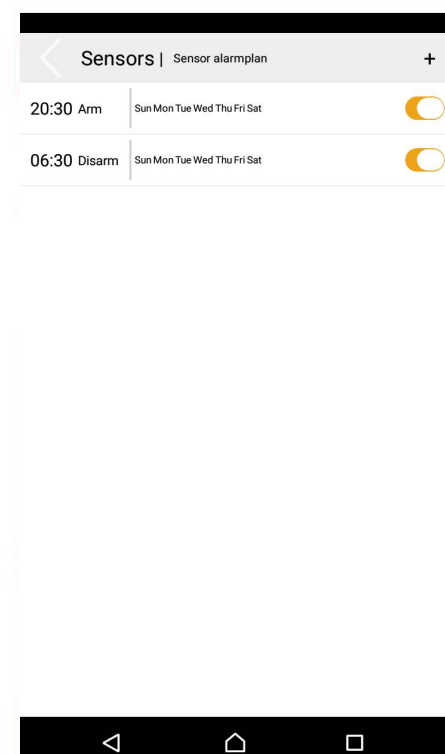

## » Step 3

- The system can delay the arming of the alarm per sensor. Click Delaytime on

- Click arrow

- Select delay time

- Click here to return to main menu.

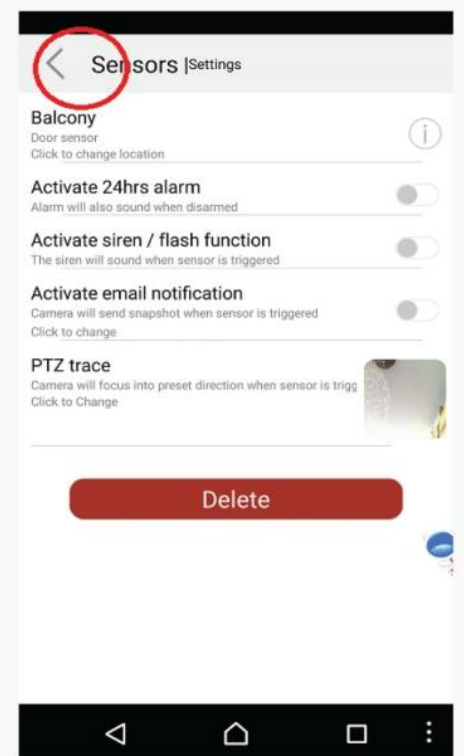
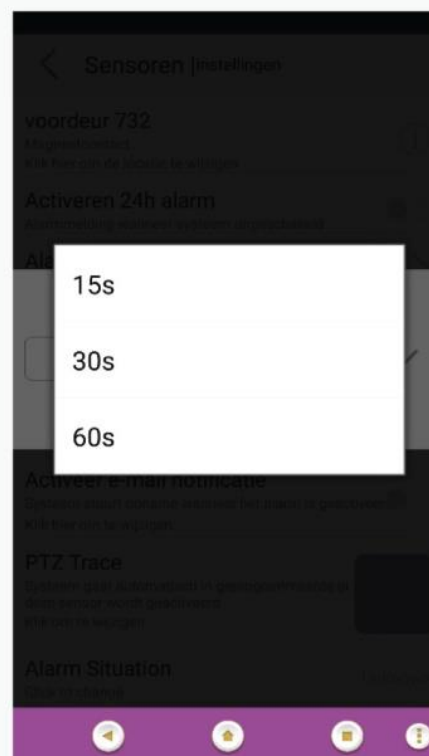
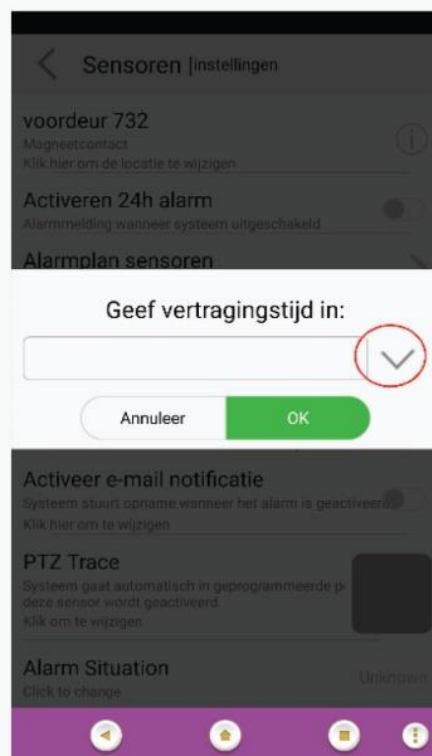
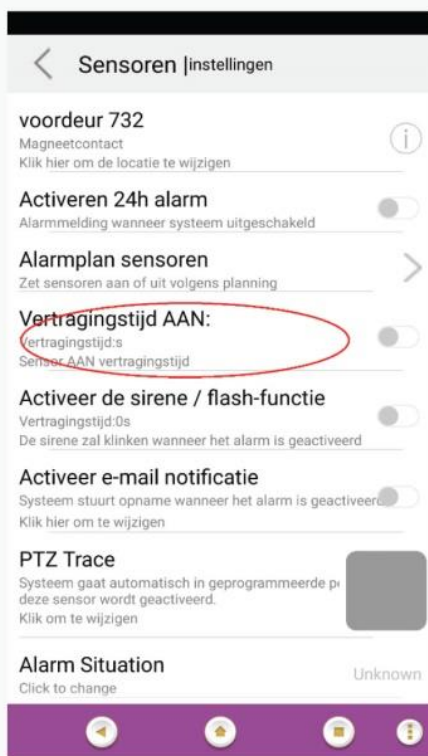



## » Step 4

### How to use the Remote Control

- First button: To DISARM the system if pushed for 3 seconds.
- Second button: To ARM the system if pushed for 3 seconds.
- Third button: To turn Siren off after the alarm is triggered
- Fourth button: Used as PANIC BUTTON. Will RECORD and TRIGGER SIREN (when connected) if pushed for 3 seconds.

